

## 6 Connect the water supply

All fittings are supplied apart from the isolation valve.

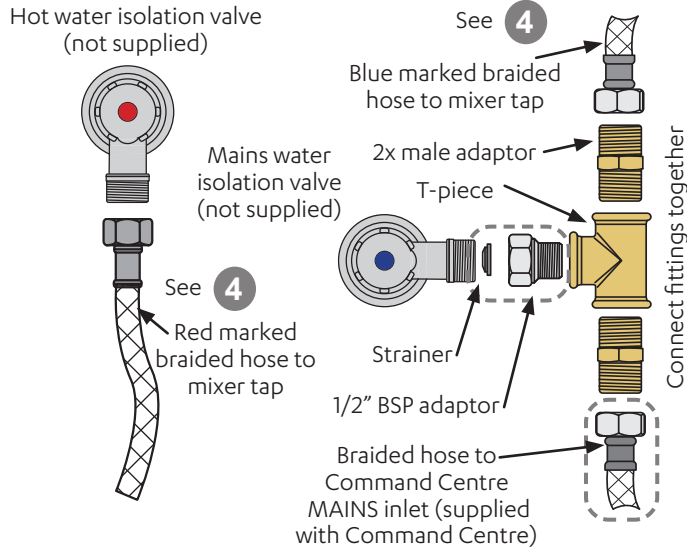
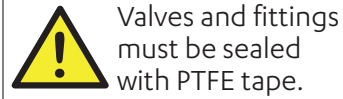

## 7 Command Centre connections

|               |                                                                                  |
|---------------|----------------------------------------------------------------------------------|
| Mains In      | Mains potable water supply.                                                      |
| USB           | Connected to the Tap.                                                            |
| Boiling out   | Red silicone tube from tap. Cut to length.                                       |
| Chilled out   | (BC) Blue silicone tube from tap,<br>(BCS) Blue JG pipe from tap. Cut to length. |
| Vent          | Clear silicone tube from tap. Cut to length.                                     |
| Sparkling out | White JG pipe from tap. Cut to length.                                           |

## 8 Cleaning and general maintenance

Wipe surfaces with a damp cloth and then wipe dry with a clean, dry cloth. Do not use strong, corrosive or abrasive cleaning materials.

Installation instructions

# Zip HydroTap

Classic / Classic Plus All-in-One Mains Mixer  
BC, BCS



**Zip Water (Aust) Pty Ltd**

ABN 46 000 578 727

67 - 77 Allingham Street, Condell Park, NSW 2200  
Postal: Locked Bag 80, Bankstown 1885, Australia  
(+612) 9796 3100 | Free Call (Aust): 1800 947 827

[www.zipwater.com](http://www.zipwater.com)

**Zip Water UK**

Trafalgar House  
Rash's Green, Dereham,  
Norfolk NR19 1JG

0345 6 005 005 | [sales@zipindustries.co.uk](mailto:sales@zipindustries.co.uk)

[specify.zipwater.co.uk](http://specify.zipwater.co.uk)

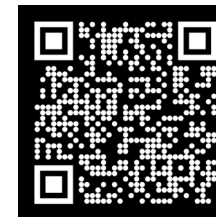

Australia



UK

Visit our website to download the manuals

## Using these instructions

Please refer to all safety and installation requirements detailed in the Quick start guide provided with the HydroTap Command Centre, and HydroTap Command Centre installation instructions found online, prior to installation of, or any change to, the complete system.



**WARNING**



Read the instructions

Before commencing the installation, download & read the HydroTap Command Centre installation instructions

## Tools needed for tap installation

In addition to normal tools, the following (or equivalent equipment) will be required.

- 50mm diameter sheet metal hole punch for sinks.
- 50mm diameter hole saw for worktops.
- Tube spanner for fixing the tap assembly (supplied).



Be aware of the risks of hazards which could cause harm when using tools. Assess the risks before starting the installation.

## Water supply pressure requirements

|                    | Min - Max pressure, kPA (bar) |                       |
|--------------------|-------------------------------|-----------------------|
|                    | Australia                     | UK                    |
| HydroTap           | 170 (1.7) - 700 (7.0)         | 170 (1.7) - 500 (5.0) |
| Sparkling HydroTap | 250 (2.5) - 700 (7.0)         | 250 (2.5) - 500 (5.0) |
| Booster            | 200 (2.0) - 700 (7.0)         | 200 (2.0) - 500 (5.0) |

## 1 Positioning

Position the tap such that it dispenses into the sink bowl with ample clearance for a cup or tea pot.



Ensure that taps are positioned to minimise the risks of scalding when dispensing boiling water.

Position Command Centre and Tap as close together as possible. See below.

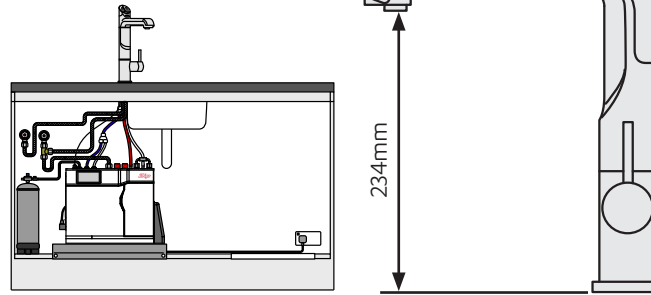

## 2 Cut the hole



Cut a Ø50mm hole in the worktop / sink.

## 3 Familiarise yourself with the base clamp

Check the hose, USB, and pipe positions on the base clamp.

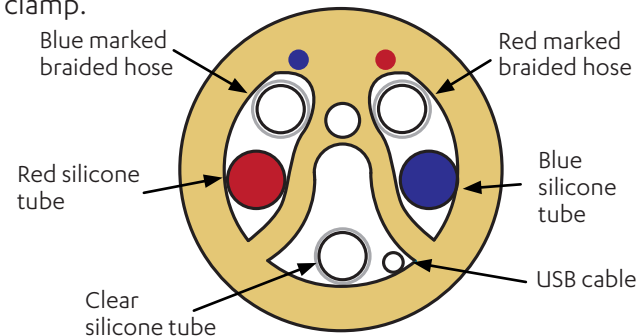

## 4 Familiarise yourself with the tap connections

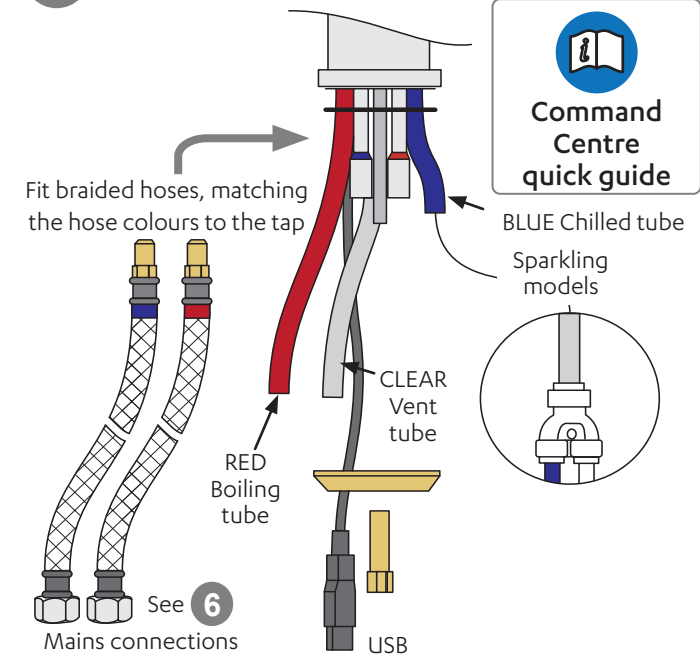

## 5 Mount and secure the tap

Use a tube spanner to secure the tap in place.

